

# HIGH TENSILE FASTNUTS (INDIA) PVT. LTD.



## DIMENSIONAL DETAILS

### Copper plated Weld Stud M6...

|                |          |
|----------------|----------|
| HTF code-----> | WS 6...  |
| Pitch          | 1.00     |
| Head Dia       | 7.15     |
|                | 6.75     |
| Head Thickness | 0.80     |
| Neck Radius    | Max. 0.5 |

### HTF Drwg : Copper plated Weld Stud M6x20

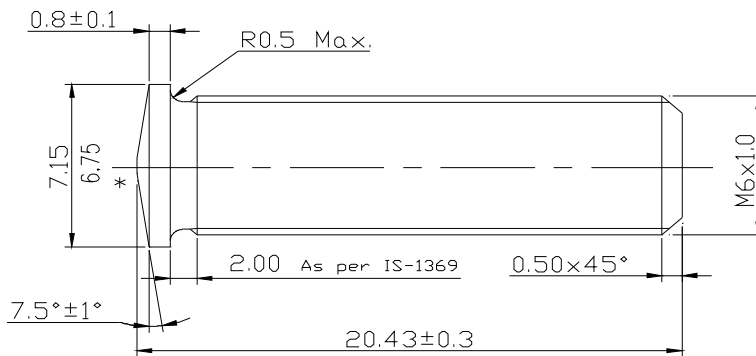

\* NON FLLING AREA AT HEAD CENTER IS PERMISSIBLE DUE TO AIR POCKET DURING FORGING.